

EFFECTIVE AFTER MAY 10, 2018  
**AMSTERDAM**

DECK PLANS & STATEROOMS

The deck plans are color-coded by category of stateroom, and the category letter precedes the stateroom number in each room. All staterooms are equipped with flat-panel television, DVD player, telephone and multichannel music.

**Important Note:** Not all staterooms within each category have the same furniture configuration and/or facilities. Appropriate symbols within the rooms on the deck plans describe differences from the stateroom descriptions below.

All information is subject to change.

**STATEROOM SYMBOL LEGEND**

- Quad (2 lower beds, 1 sofa bed, 1 upper)
- Triple (2 lower beds, 1 sofa bed)
- ▲ 2 lower beds or converts to 1 queen-size
- △ Partial sea view
- X Fully obstructed view
- \* Shower only
- Bathtub & shower
- + Connecting rooms
- ◇ These staterooms have portholes instead of windows

**ACCESSIBILITY STATEROOM SYMBOL LEGEND**

- ♿ Suites B6228 & B6225 and stateroom EE3431 are fully accessible, roll-in shower only
- ▼ Suites SA7058 & SA7057 are fully accessible with single side approach to the bed with bathtub & roll-in shower. Staterooms DA6104, G1805 & G1804 are fully accessible with single side approach to the bed, roll-in shower only.
- ★ Staterooms HH3433, HH3428, H3394, H3393, E2702, L2700, J2555, J2554, G2500, FF1964, FF1955, G1807 & G1806 are ambulatory accessible, roll-in shower only

**OCEAN-VIEW STATEROOMS**

- D □ E □ EE □ F □ FF

**Large:** 2 lower beds convertible to 1 queen-size bed, bathtub & shower. Approximately 140–319 sq. ft.

**G**

**Large:** 2 lower beds convertible to 1 queen-size bed, bathtub & shower. All G-category staterooms have portholes. Approximately 140–319 sq. ft.

**INTERIOR STATEROOMS**

- J □ M □ MM □ N

**Large:** 2 lower beds convertible to 1 queen-size bed, shower. Approximately 182–293 sq. ft.

**DECK 1—DOLPHIN DECK**  
Staterooms 1800–1964

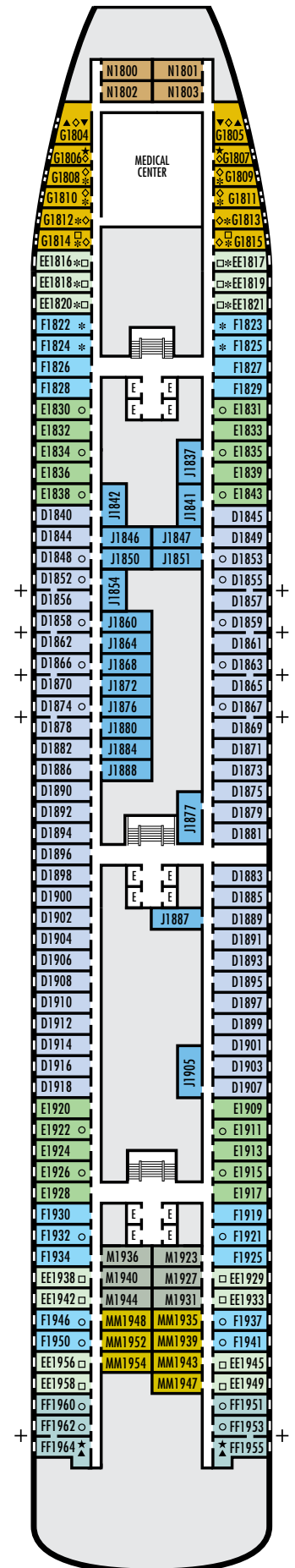

Dolphin Deck

EFFECTIVE AFTER MAY 10, 2018  
**AMSTERDAM**

DECK PLANS & STATEROOMS

The deck plans are color-coded by category of stateroom, and the category letter precedes the stateroom number in each room. All staterooms are equipped with flat-panel television, DVD player, telephone and multichannel music.

**Important Note:** Not all staterooms within each category have the same furniture configuration and/or facilities. Appropriate symbols within the rooms on the deck plans describe differences from the stateroom descriptions below.

All information is subject to change.

STATEROOM SYMBOL LEGEND

- Quad (2 lower beds, 1 sofa bed, 1 upper)
- Triple (2 lower beds, 1 sofa bed)
- ▲ 2 lower beds or converts to 1 queen-size
- △ Partial sea view
- × Fully obstructed view
- \* Shower only
- Bathtub & shower
- + Connecting rooms
- ◇ These staterooms have portholes instead of windows

ACCESSIBILITY STATEROOM SYMBOL LEGEND

- ♿ Suites B6228 & B6225 and stateroom EE3431 are fully accessible, roll-in shower only
- ▼ Suites SA7058 & SA7057 are fully accessible with single side approach to the bed with bathtub & roll-in shower. Staterooms DA6104, G1805 & G1804 are fully accessible with single side approach to the bed, roll-in shower only.
- ★ Staterooms HH3433, HH3428, H3394, H3393, E2702, L2700, J2555, J2554, G2500, FF1964, FF1955, G1807 & G1806 are ambulatory accessible, roll-in shower only

OCEAN-VIEW STATEROOMS

- C DA DD E

**Large:** 2 lower beds convertible to 1 queen-size bed, bathtub & shower.  
Approximately 140–319 sq. ft.

G

**Large:** 2 lower beds convertible to 1 queen-size bed, bathtub & shower. All G-category staterooms have portholes.  
Approximately 140–319 sq. ft.

INTERIOR STATEROOMS

- J K L M

**Large:** 2 lower beds convertible to 1 queen-size bed, shower.  
Approximately 182–293 sq. ft.

DECK 2—MAIN DECK  
Staterooms 2500–2715

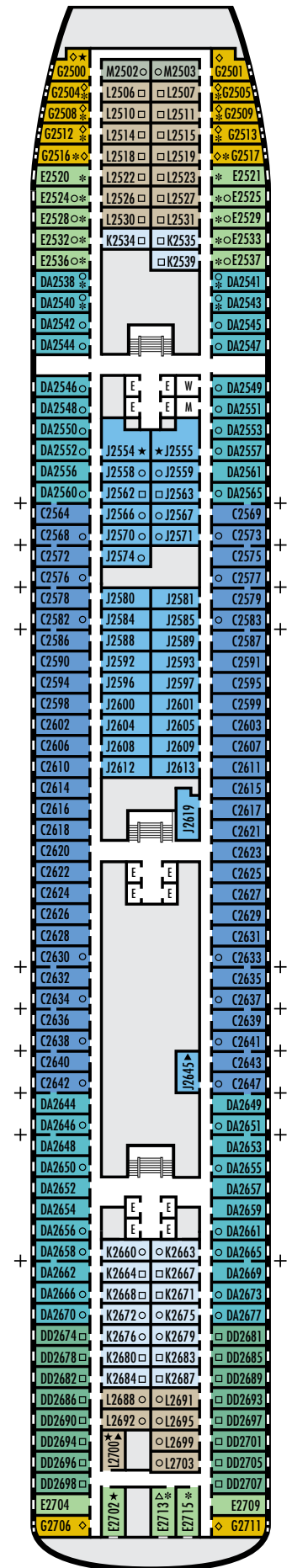

Main Deck



EFFECTIVE AFTER MAY 10, 2018  
**AMSTERDAM**

DECK PLANS & STATEROOMS

The deck plans are color-coded by category of stateroom, and the category letter precedes the stateroom number in each room. All staterooms are equipped with flat-panel television, DVD player, telephone and multichannel music.

**Important Note:** Not all staterooms within each category have the same furniture configuration and/or facilities. Appropriate symbols within the rooms on the deck plans describe differences from the stateroom descriptions below.

All information is subject to change.

**STATEROOM SYMBOL LEGEND**

- Quad (2 lower beds, 1 sofa bed, 1 upper)
- Triple (2 lower beds, 1 sofa bed)
- ▲ 2 lower beds or converts to 1 queen-size
- △ Partial sea view
- × Fully obstructed view
- \* Shower only
- Bathtub & shower
- + Connecting rooms
- ◇ These staterooms have portholes instead of windows

**ACCESSIBILITY STATEROOM SYMBOL LEGEND**

- ♿ Suites B6228 & B6225 and stateroom EE3431 are fully accessible, roll-in shower only
- ▼ Suites SA7058 & SA7057 are fully accessible with single side approach to the bed with bathtub & roll-in shower. Staterooms DA6104, G1805 & G1804 are fully accessible with single side approach to the bed, roll-in shower only.
- ★ Staterooms HH3433, HH3428, H3394, H3393, E2702, L2700, J2555, J2554, G2500, FF1964, FF1955, G1807 & G1806 are ambulatory accessible, roll-in shower only

**OCEAN-VIEW STATEROOMS**

- CA**  
**Lanai:** 2 lower beds convertible to 1 queen-size bed, shower. Sliding glass doors lead onto the walk-around Lower Promenade Deck. Approximately 196–240 sq. ft.
- D E EE**  
**Large:** 2 lower beds convertible to 1 queen-size bed, bathtub & shower. Approximately 140–319 sq. ft.
- H HH**  
**Large:** 2 lower beds convertible to 1 queen-size bed, bathtub & shower. All H-category staterooms have partial sea views. All HH-category staterooms have fully obstructed views. Approximately 140–319 sq. ft.

**INTERIOR STATEROOMS**

- I L**  
**Large:** 2 lower beds convertible to 1 queen-size bed, shower. Approximately 182–293 sq. ft.

**DECK 3—LOWER PROMENADE DECK**  
Staterooms 3300–3433

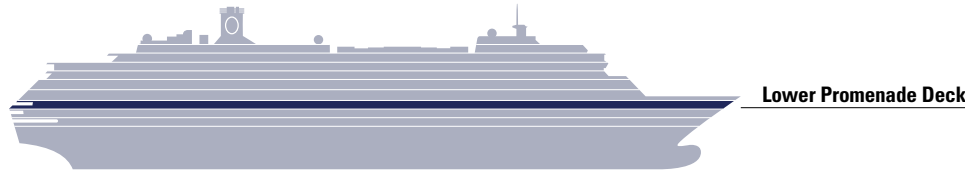
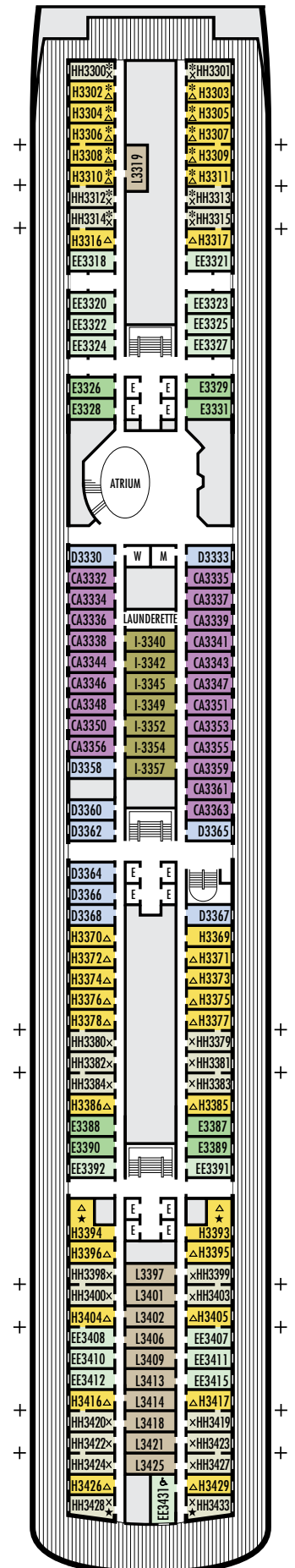

EFFECTIVE AFTER MAY 10, 2018  
**AMSTERDAM**

DECK PLANS & STATEROOMS

The deck plans are color-coded by category of stateroom, and the category letter precedes the stateroom number in each room. All staterooms are equipped with flat-panel television, DVD player, telephone and multichannel music.

**Important Note:** Not all staterooms within each category have the same furniture configuration and/or facilities. Appropriate symbols within the rooms on the deck plans describe differences from the stateroom descriptions below.

All information is subject to change.

**STATEROOM SYMBOL LEGEND**

- Quad (2 lower beds, 1 sofa bed, 1 upper)
- Triple (2 lower beds, 1 sofa bed)
- ▲ 2 lower beds or converts to 1 queen-size
- △ Partial sea view
- × Fully obstructed view
- \* Shower only
- Bathtub & shower
- + Connecting rooms
- ◇ These staterooms have portholes instead of windows

**ACCESSIBILITY STATEROOM SYMBOL LEGEND**

- ♿ Suites B6228 & B6225 and stateroom EE3431 are fully accessible, roll-in shower only
- ▼ Suites SA7058 & SA7057 are fully accessible with single side approach to the bed with bathtub & roll-in shower. Staterooms DA6104, G1805 & G1804 are fully accessible with single side approach to the bed, roll-in shower only.
- ★ Staterooms HH3433, HH3428, H3394, H3393, E2702, L2700, J2555, J2554, G2500, FF1964, FF1955, G1807 & G1806 are ambulatory accessible, roll-in shower only



Promenade Deck

DECK 4—PROMENADE DECK

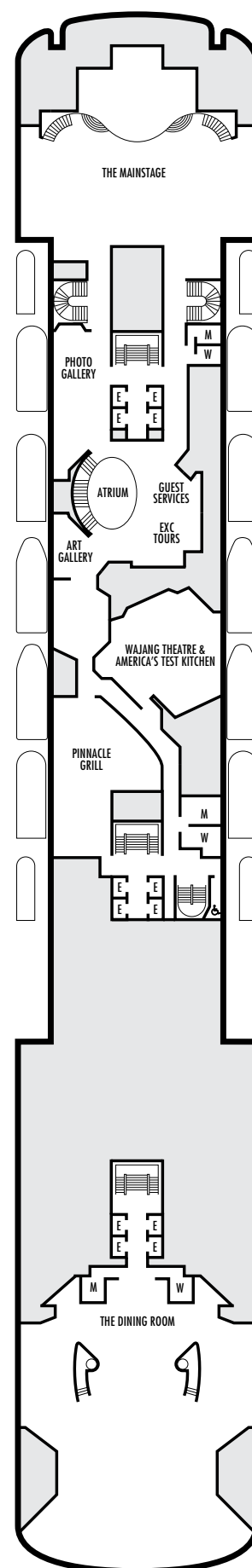

EFFECTIVE AFTER MAY 10, 2018  
**AMSTERDAM**

DECK PLANS & STATEROOMS

The deck plans are color-coded by category of stateroom, and the category letter precedes the stateroom number in each room. All staterooms are equipped with flat-panel television, DVD player, telephone and multichannel music.

**Important Note:** Not all staterooms within each category have the same furniture configuration and/or facilities. Appropriate symbols within the rooms on the deck plans describe differences from the stateroom descriptions below.

All information is subject to change.

**STATEROOM SYMBOL LEGEND**

- Quad (2 lower beds, 1 sofa bed, 1 upper)
- Triple (2 lower beds, 1 sofa bed)
- ▲ 2 lower beds or converts to 1 queen-size
- △ Partial sea view
- × Fully obstructed view
- \* Shower only
- Bathtub & shower
- + Connecting rooms
- ◇ These staterooms have portholes instead of windows

**ACCESSIBILITY STATEROOM SYMBOL LEGEND**

- ♿ Suites B6228 & B6225 and stateroom EE3431 are fully accessible, roll-in shower only
- ▼ Suites SA7058 & SA7057 are fully accessible with single side approach to the bed with bathtub & roll-in shower. Staterooms DA6104, G1805 & G1804 are fully accessible with single side approach to the bed, roll-in shower only.
- ★ Staterooms HH3433, HH3428, H3394, H3393, E2702, L2700, J2555, J2554, G2500, FF1964, FF1955, G1807 & G1806 are ambulatory accessible, roll-in shower only



Upper Promenade Deck

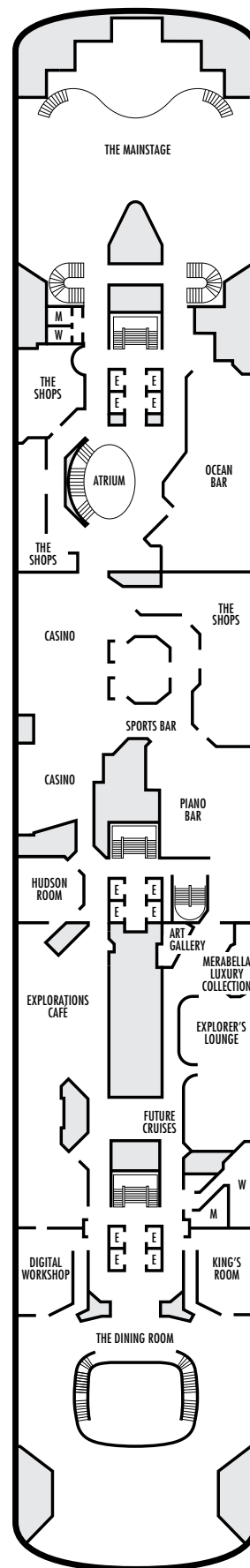

EFFECTIVE AFTER MAY 10, 2018  
**AMSTERDAM**

DECK PLANS & STATEROOMS

The deck plans are color-coded by category of stateroom, and the category letter precedes the stateroom number in each room. All staterooms are equipped with flat-panel television, DVD player, telephone and multichannel music.

**Important Note:** Not all staterooms within each category have the same furniture configuration and/or facilities. Appropriate symbols within the rooms on the deck plans describe differences from the stateroom descriptions below.

All information is subject to change.

**STATEROOM SYMBOL LEGEND**

- Quad (2 lower beds, 1 sofa bed, 1 upper)
- Triple (2 lower beds, 1 sofa bed)
- ▲ 2 lower beds or converts to 1 queen-size
- △ Partial sea view
- × Fully obstructed view
- \* Shower only
- Bath tub & shower
- + Connecting rooms
- ◇ These staterooms have portholes instead of windows

**ACCESSIBILITY STATEROOM SYMBOL LEGEND**

- ♿ Suites B6228 & B6225 and stateroom EE3431 are fully accessible, roll-in shower only
- ▼ Suites SA7058 & SA7057 are fully accessible with single side approach to the bed with bathtub & roll-in shower. Staterooms DA6104, G1805 & G1804 are fully accessible with single side approach to the bed, roll-in shower only.
- ★ Staterooms HH3433, HH3428, H3394, H3393, E2702, L2700, J2555, J2554, G2500, FF1964, FF1955, G1807 & G1806 are ambulatory accessible, roll-in shower only

**VERANDAH SUITES**

- A ■ B ■ BB ■ BC

**Vista Suites:** 2 lower beds convertible to 1 queen-size bed, whirlpool bath & shower, sitting area, private verandah, mini-bar, refrigerator, floor-to-ceiling windows.  
Approximately 295–337 sq. ft. including verandah.

**OCEAN-VIEW STATEROOMS**

- DA

**Large:** 2 lower beds convertible to 1 queen-size bed, bathtub & shower.  
Approximately 140–319 sq. ft.

**INTERIOR STATEROOMS**

- I ■ K

**Large:** 2 lower beds convertible to 1 queen-size bed, shower.  
Approximately 182–293 sq. ft.

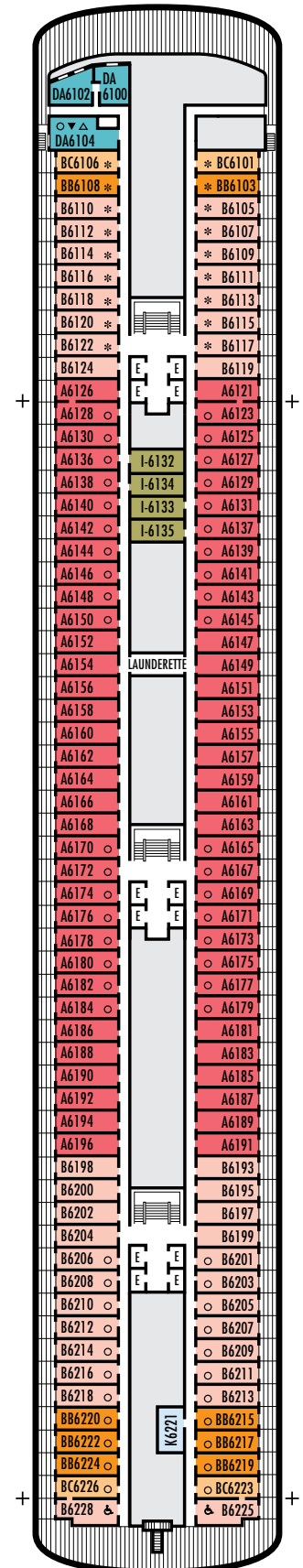

Verandah Deck

EFFECTIVE AFTER MAY 10, 2018  
**AMSTERDAM**

DECK PLANS & STATEROOMS

The deck plans are color-coded by category of stateroom, and the category letter precedes the stateroom number in each room. All staterooms are equipped with flat-panel television, DVD player, telephone and multichannel music.

**Important Note:** Not all staterooms within each category have the same furniture configuration and/or facilities. Appropriate symbols within the rooms on the deck plans describe differences from the stateroom descriptions below.

All information is subject to change.

**STATEROOM SYMBOL LEGEND**

- Quad (2 lower beds, 1 sofa bed, 1 upper)
- Triple (2 lower beds, 1 sofa bed)
- ▲ 2 lower beds or converts to 1 queen-size
- △ Partial sea view
- × Fully obstructed view
- \* Shower only
- Bathtub & shower
- + Connecting rooms
- ◇ These staterooms have portholes instead of windows

**ACCESSIBILITY STATEROOM SYMBOL LEGEND**

- ♿ Suites B6228 & B6225 and stateroom EE3431 are fully accessible, roll-in shower only
- ▼ Suites SA7058 & SA7057 are fully accessible with single side approach to the bed with bathtub & roll-in shower. Staterooms DA6104, G1805 & G1804 are fully accessible with single side approach to the bed, roll-in shower only.
- ★ Staterooms HH3433, HH3428, H3394, H3393, E2702, L2700, J2555, J2554, G2500, FF1964, FF1955, G1807 & G1806 are ambulatory accessible, roll-in shower only

**VERANDAH SUITES**

**PS**

**Pinnacle Suites:** Bedroom with 1 king-size bed, oversize whirlpool bath & shower, living room, dining room, dressing room, private verandah, pantry, 1 sofa bed for 2 persons, mini-bar, refrigerator, guest toilet, floor-to-ceiling windows. Approximately 1,181 sq. ft. including verandah.

**SA SB**

**Neptune Suites:** 2 lower beds convertible to 1 king-size bed, whirlpool bath & shower, large sitting area, dressing room, private verandah, 1 sofa bed for 2 persons, mini-bar, refrigerator, floor-to-ceiling windows. Approximately 568–644 sq. ft. including verandah.

**OCEAN-VIEW STATEROOMS**

**H**

**Large:** 2 lower beds convertible to 1 queen-size bed, bathtub & shower. All H-category staterooms have partial sea views. Approximately 140–319 sq. ft.

**INTERIOR STATEROOMS**

**K**

**Large:** 2 lower beds convertible to 1 queen-size bed, shower. Approximately 182–293 sq. ft.

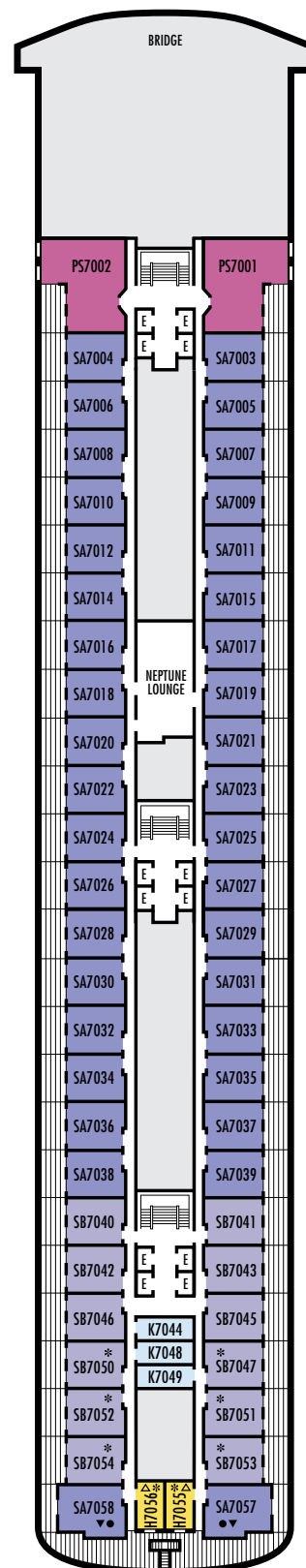

Navigation Deck



EFFECTIVE AFTER MAY 10, 2018  
**AMSTERDAM**

DECK PLANS & STATEROOMS

The deck plans are color-coded by category of stateroom, and the category letter precedes the stateroom number in each room. All staterooms are equipped with flat-panel television, DVD player, telephone and multichannel music.

**Important Note:** Not all staterooms within each category have the same furniture configuration and/or facilities. Appropriate symbols within the rooms on the deck plans describe differences from the stateroom descriptions below.

All information is subject to change.

**STATEROOM SYMBOL LEGEND**

- Quad (2 lower beds, 1 sofa bed, 1 upper)
- Triple (2 lower beds, 1 sofa bed)
- ▲ 2 lower beds or converts to 1 queen-size
- △ Partial sea view
- × Fully obstructed view
- \* Shower only
- Bathtub & shower
- + Connecting rooms
- ◇ These staterooms have portholes instead of windows

**ACCESSIBILITY STATEROOM SYMBOL LEGEND**

- ♿ Suites B6228 & B6225 and stateroom EE3431 are fully accessible, roll-in shower only
- ▼ Suites SA7058 & SA7057 are fully accessible with single side approach to the bed with bathtub & roll-in shower. Staterooms DA6104, G1805 & G1804 are fully accessible with single side approach to the bed, roll-in shower only.
- ★ Staterooms HH3433, HH3428, H3394, H3393, E2702, L2700, J2555, J2554, G2500, FF1964, FF1955, G1807 & G1806 are ambulatory accessible, roll-in shower only

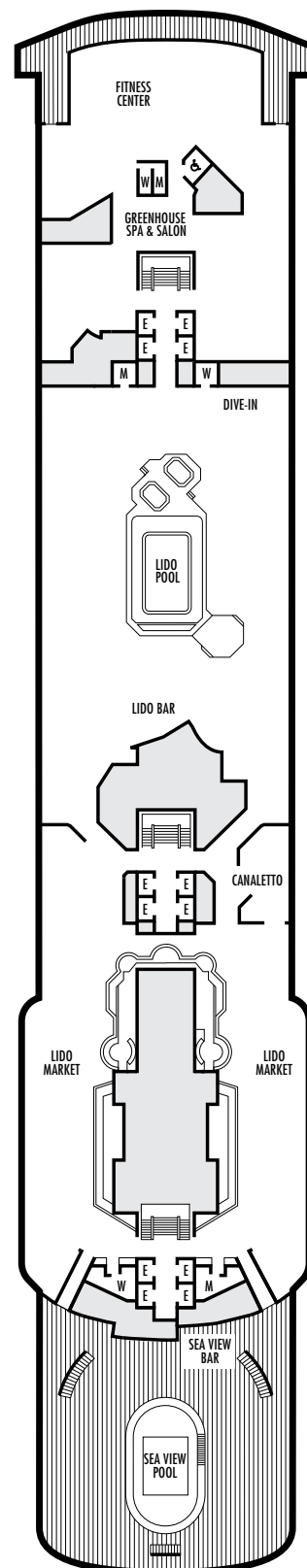

Lido Deck





EFFECTIVE AFTER MAY 10, 2018  
**AMSTERDAM**

DECK PLANS & STATEROOMS

The deck plans are color-coded by category of stateroom, and the category letter precedes the stateroom number in each room. All staterooms are equipped with flat-panel television, DVD player, telephone and multichannel music.

**Important Note:** Not all staterooms within each category have the same furniture configuration and/or facilities. Appropriate symbols within the rooms on the deck plans describe differences from the stateroom descriptions below.

All information is subject to change.

**STATEROOM SYMBOL LEGEND**

- Quad (2 lower beds, 1 sofa bed, 1 upper)
- Triple (2 lower beds, 1 sofa bed)
- ▲ 2 lower beds or converts to 1 queen-size
- △ Partial sea view
- × Fully obstructed view
- \* Shower only
- Bathtub & shower
- + Connecting rooms
- ◇ These staterooms have portholes instead of windows

**ACCESSIBILITY STATEROOM SYMBOL LEGEND**

- ♿ Suites B6228 & B6225 and stateroom EE3431 are fully accessible, roll-in shower only
- ▼ Suites SA7058 & SA7057 are fully accessible with single side approach to the bed with bathtub & roll-in shower. Staterooms DA6104, G1805 & G1804 are fully accessible with single side approach to the bed, roll-in shower only.
- ★ Staterooms HH3433, HH3428, H3394, H3393, E2702, L2700, J2555, J2554, G2500, FF1964, FF1955, G1807 & G1806 are ambulatory accessible, roll-in shower only

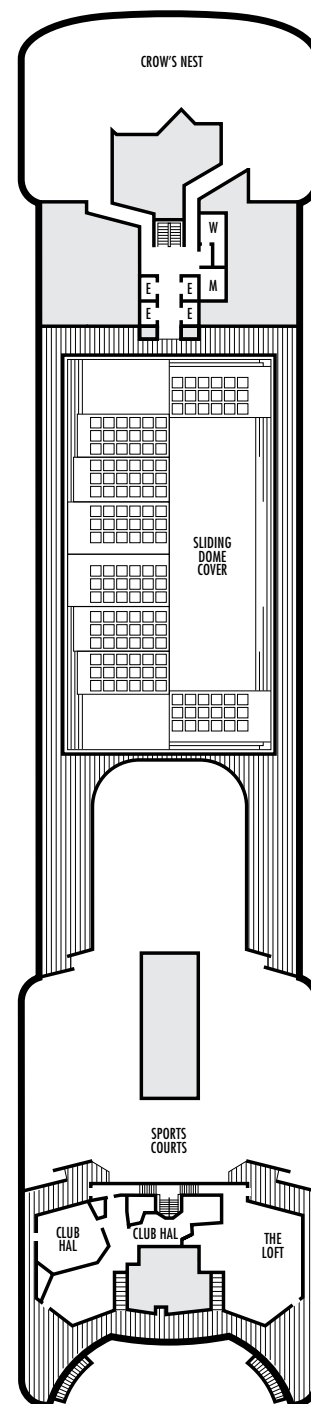

Sports Deck

